

Part #: PT923-00097

NOTE: Part number of this accessory may not be the same as the part number shown.

Conflicts: JBL Audio

Kit Contents:



Hardware Content

Item#	Quantity Req'd.	Description
1	1	Interface Module
2	1	Main Power Harness
3	1	BLU Logic Switch
4	1	Microphone
5	15	9.5" Lock Ties
6	2	Adhesive Foam Pad
7	1	Owner's Manual
8	33 cm	1/4" Wire Split Loom

Additional Items (may be required)

Item#	Quantity Req'd.	Description

Recommended Sequence of Application

Item#	Quantity Req'd.	Description

Vehicle Service Parts (may be required for reassembly)

Item#	Quantity Req'd.	Description

General Applicability

Note:

Recommended Tools

Personal & Vehicle Protection	Notes
Safety Goggles	
Seat Covers	
Floor Covers	
Special Tools	
Panel Clip Removal	SST # 00002-06001-01
Sockets	10 mm
Screwdriver	Phillips, #2
Side Cutters	
Torque Wrench	36 in-lbf (4.07 N.m)
Installation Tools	Notes
Masking Tape	VDC Supplied
Foam Tape	VDC Supplied
Special Chemicals	
Cleaner	VDC Approved Cleaner

Legend

- STOP:** Damage to the vehicle may occur. Do not proceed until process has been complied with.
- CAUTION:** A process that must be carefully observed in order to reduce the risk of damage to the accessory/vehicle.
- OPERATOR SAFETY:** Use caution to avoid risk of injury.
- TOOLS & EQUIPMENT:** Used in Figures to call out the specific tools and equipment recommended for the process.
- REVISION MARK:** This mark highlights a change in installation with respect to previous issue.
- SAFETY TORQUE:** This mark indicates that torque is related to safety.
- VIDEO:** Video Available; click to Play

Table of Contents

I. Preparation	1-2
1. Table Of Contents.....	2
2. Content Location.....	3
II. Procedure	4-11
1. Vehicle Preparation.....	4
2. Vehicle Disassembly.....	4
3. Microphone Installation.....	5
4. Interface Module Installation.....	6
5. BLU Logic Switch Installation Option I.....	7
6. BLU Logic Switch Installation Option II	10
7. Finalizing the Installation	11
III. Checklist	12
1. Accessory Function Checks.....	12
2. Vehicle Function Checks.....	12

Accessory Installation Practice (read before installation)

Care must be taken when installing this accessory to ensure damage does not occur to the vehicle. The installation of this accessory should follow approved guidelines to ensure a quality installation.

These guidelines can be found in the “Accessory Installation Practices” document.

This document covers such items as:

- Vehicle Protection (use of covers and blankets, cleaning chemicals, etc.)
- Safety (eye protection, checking torque procedure, etc.)
- Vehicle Disassembly/Reassembly (panel removal, part storage, etc.)
- Electrical Component Disassembly/Reassembly (battery disconnection, connector removal, etc.)

Please see your Toyota/Scion/Lexus dealer for a copy of this document.

Content Location	
1	Interface Module
2	Wired Microphone
3	BLU Logic Switch Location - Option I
4	BLU Logic Switch Location - Option II

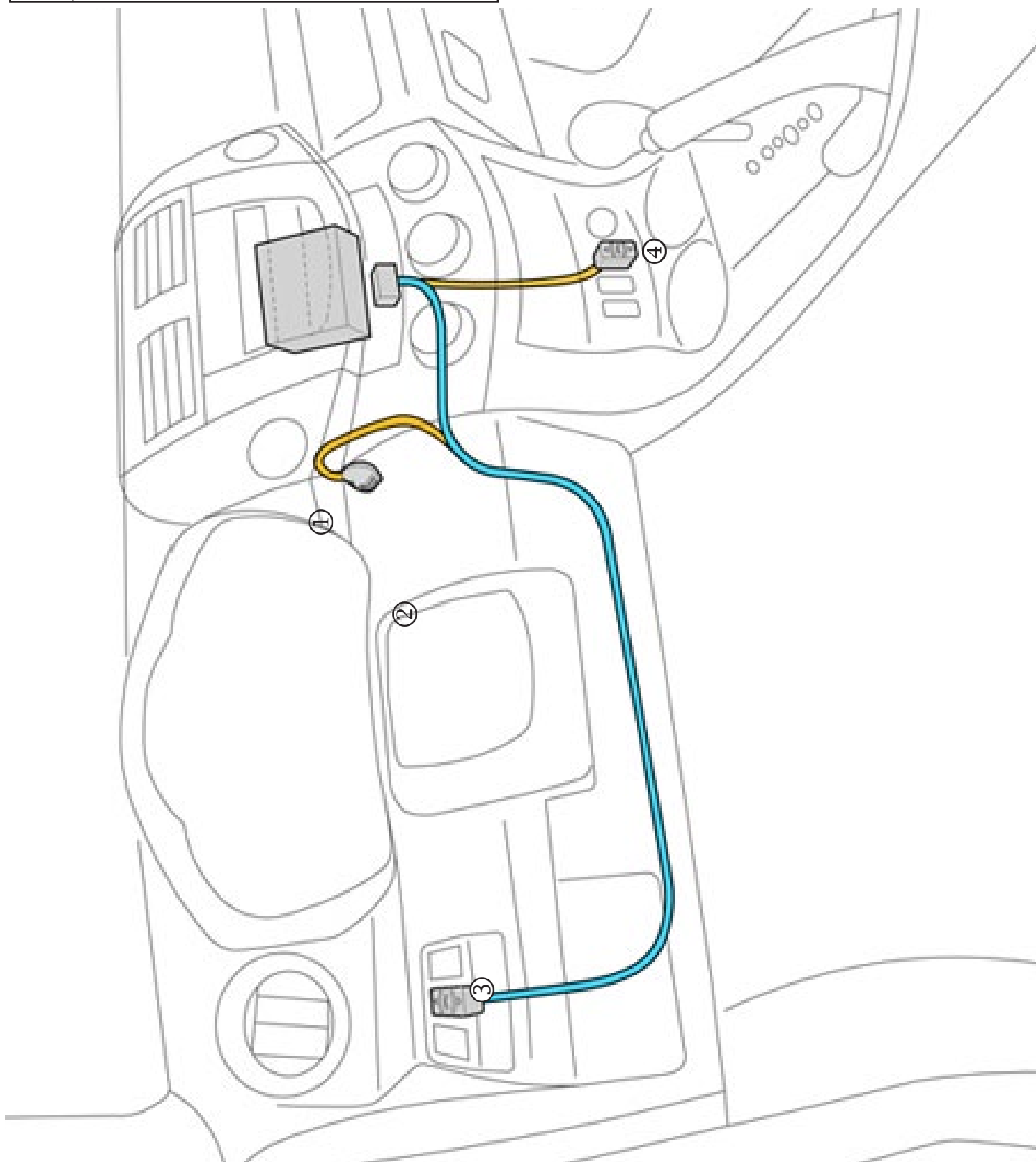



1. Vehicle Preparation (Fig. 1-1)



- Apply parking brake.
- Protect fender before starting.
- Remove the negative (-) battery terminal.



CAUTION: Do not touch the positive terminal with any tool during removal.

- Using the protective blanket, cover front seat, side of the shift lever and center console.
- Place removed vehicle components on a protective blanket.



2. Vehicle Disassembly

- Remove the radio assembly.



1. Apply protective tape to the area below the left and right trim panel (Fig. 1-2).



2. Using a panel removal tool, remove the right and left trim panels (Fig. 1-3).

NOTE: Start from the bottom and work your way up.



3. Remove the four (4) bolts securing the radio with a 10mm socket/ratchet (Fig. 1-4).



4. Gently pull out the radio and disconnect any connectors (Fig. 1-5).
5. Support the radio on a support box (or with other appropriate means) to prevent any damage to the connections as well as preventing scratches.



NOTE: Be careful not to put too much tension on the radio connections when pulling out the radio.



3. Microphone Installation

- a. Mount the microphone.

1. Remove the Phillips screw to the left of the radio (Fig. 1-6).

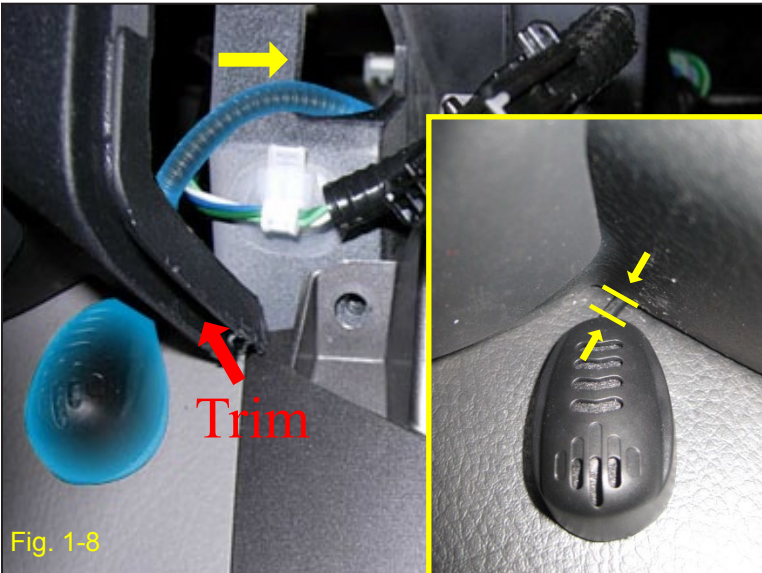

2. Wrap the microphone wire with 33cm of 1/4" wire split loom leaving a minimum of 8mm of wire exposed (Fig. 1-7).

3. Secure wire loom with tape.

NOTE: This will help eliminate any possibility of the factory plastic trim puncturing the wire.

4. Clean the microphone location with an approved VDC cleaner.
5. Now pull back on the trim to disengage, allowing enough gap for the microphone wire (Fig. 1-7).

6. Mount the rear of the microphone vertically to minimize the amount of exposed wire visible to the customer. 3-10mm of exposed wire is acceptable (Fig. 1-8).

7. Route microphone wire through the small hole marked by the yellow arrow in Figure 1-8.

8. Re-engage panel and reinstall Phillips screw.

4. Interface Module Installation

- a. Connect the main power harness to the matching interface module connections (Fig. 1-9).
- b. Also connect the microphone wire to the module.

NOTE: The Red connector is connected to the matching Red connector on the module.

DO NOT remove protective foam wrap from the module.

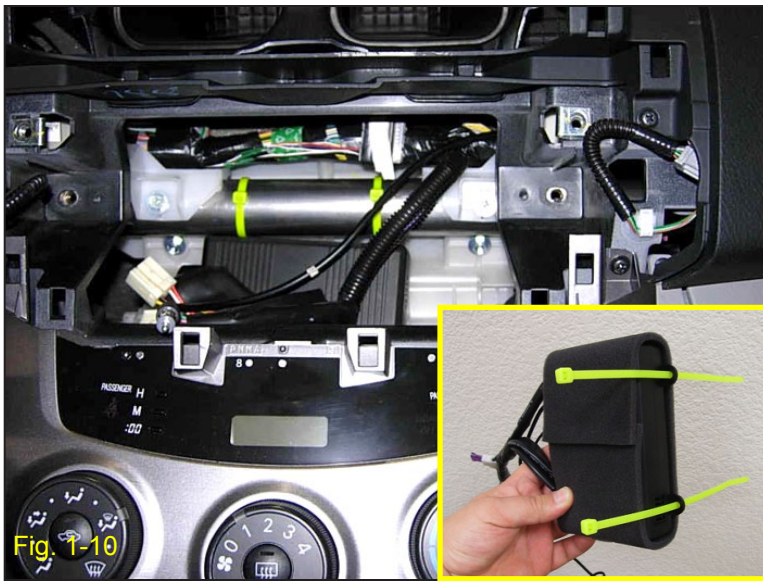

Fig. 1-10

c. Mount the interface module.

1. Insert two (2) wire ties through the module (Fig 1-10).

2. Secure the module to the cross bar.

NOTE: BLU Logic wire ties in Figure 1-10 and the remainder of these instructions will be shown in yellow.

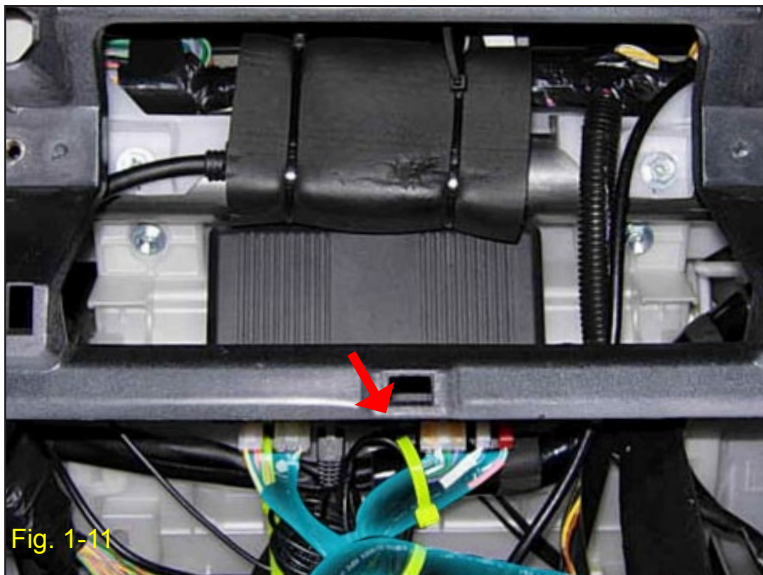

Fig. 1-11



NOTE: If vehicle is equipped with a Toyota iPod Accessory Module, rotate the module up to allow clearance to secure the BLU Logic module. (Fig. 1-11).

This note does not apply if vehicle does not come with Toyota iPod Accessory Module.

3. Secure the BLU Logic wire harness to the existing harness with a wire tie marked by the red arrow (Fig. 1-11).

5. BLU Logic Switch Installation - Option I

a. The installer can choose whether to install the switch in either the knock-out panel left of the steering wheel or in the center console. See illustration on page 3 for more detail. For installation into the panel to the left of the steering wheel, follow Option #1 (Step 5) and skip Option #2 (Step 6). For installation into the center console panel, follow Option #2 (Step 6) and skip Option #1 (Step 5).

NOTE: Either switch option is acceptable.

b. Remove the lower knee panel.

1. Use a Phillips screwdriver to remove the lower right screw on the lower knee panel (Fig. 1-12).



Fig. 1-12



2. Now remove the Phillips screw on the lower left side of the knee panel (Fig. 1-13).
3. Gently pull panel to disengage clips and disconnect any connectors.



- c. Remove the lower left panel.
 1. Apply protective tape to the right of the panel.
 2. Using a panel tool, disengage the clips and remove (Fig. 1-14).



3. Reach through the opening right under the blank plug.
4. Release the lock tabs on the middle knock-out and remove (Fig. 1-15).

NOTE: If middle knock-out is occupied, use next available knock-out.



Fig. 1-16

- d. Mount the BLU Logic switch as shown (Fig. 1-16).

NOTE: Make sure the solid arrow is pointed up.



Fig. 1-17

- e. Route the BLU Logic Switch cable.

1. Run the switch cable down through the opening of the lower left panel (Fig. 1-17).

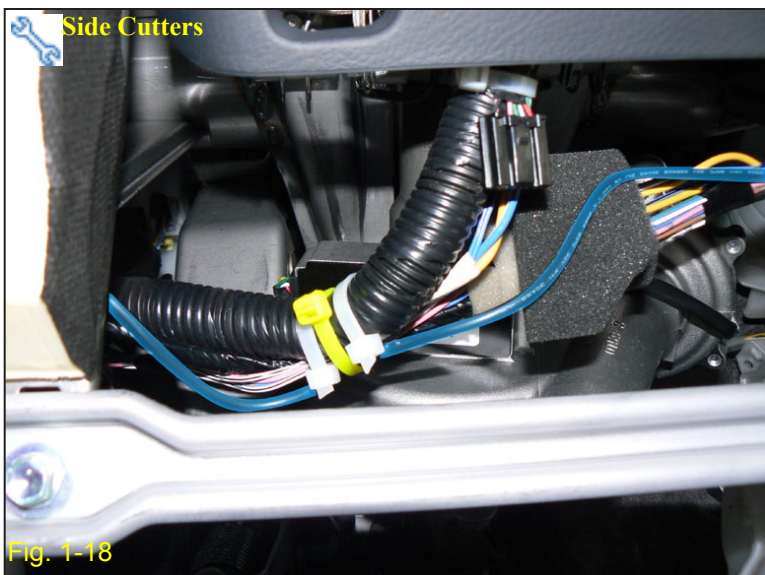

Fig. 1-18

- f. Continue towards the radio cavity, following the factory harness and staying behind the metal brace (Fig. 1-18).

+ NOTE: Metal brace is very sharp, use precaution.

1. Operate the tilt/telescopic steering column to full travels and verify wires are not pulled or pinched.
2. Remove any slack and wire tie every 5-6 inches.
3. Cut off any excess wire ties.
4. Connect cable to interface module.
5. Reinstall the lower left panel and lower knee panel.



6. BLU Logic Switch Installation - Option II

a. Remove lower switch panel.

1. Using panel removal tool, disengage the lower switch panel (Fig. 1-19).
2. Disconnect all connectors and remove.

b. Remove HVAC assembly.

1. Remove two (2) Phillips screws circled in Fig. 1-20.
2. Disengage HVAC assembly with hands.
3. Support the HVAC assembly on a support box (or with other appropriate means) to prevent any damage to the connections as well as preventing scratches.



NOTE: DO NOT disconnect HVAC connectors.

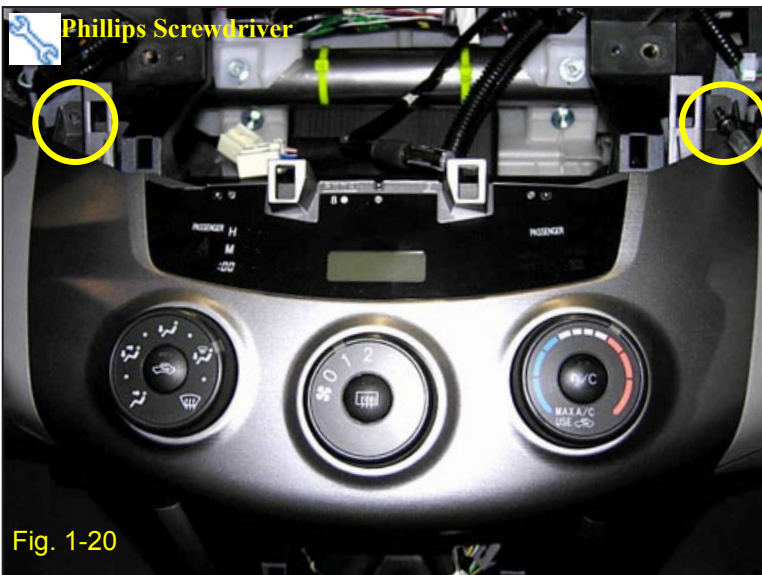

c. Route the switch cable.

1. Route down towards the left of the Radio/HVAC opening (Fig. 1-21).
2. Continue down towards the opening of the lower switch panel.
3. Leave a short pigtail that will connect to the switch.
4. Secure the switch wire to the support bar with a wire tie (Fig. 1-21).
5. Cut off excess wire ties.

NOTE: BLU Logic wire highlighted in blue.

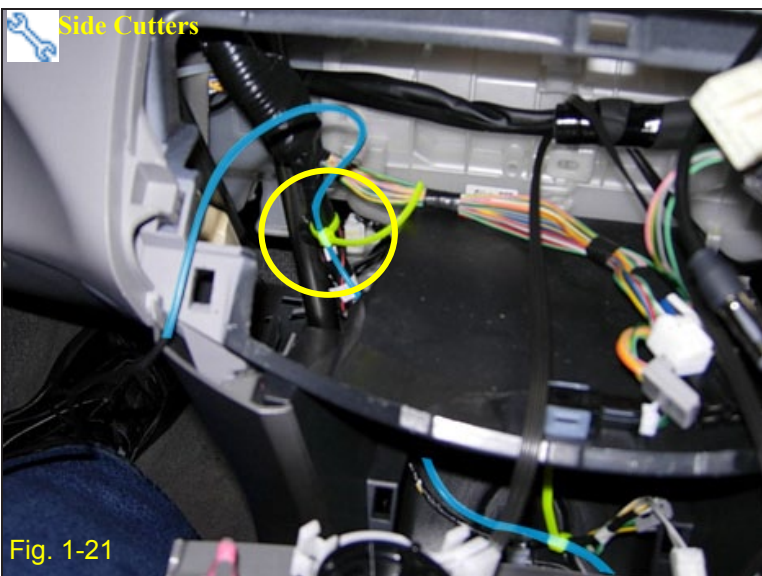



6. Secure the pigtail to the existing wire loom removed from the lower switch panel (Fig. 1-22).
- d. Mount the switch.
 1. Remove far right knock-out and mount module with solid arrow pointing up (Fig. 1-22).

NOTE: If far right knock-out is occupied, use next available knock-out.

2. Connect to pig tail and reinstall the lower switch panel and HVAC assembly.

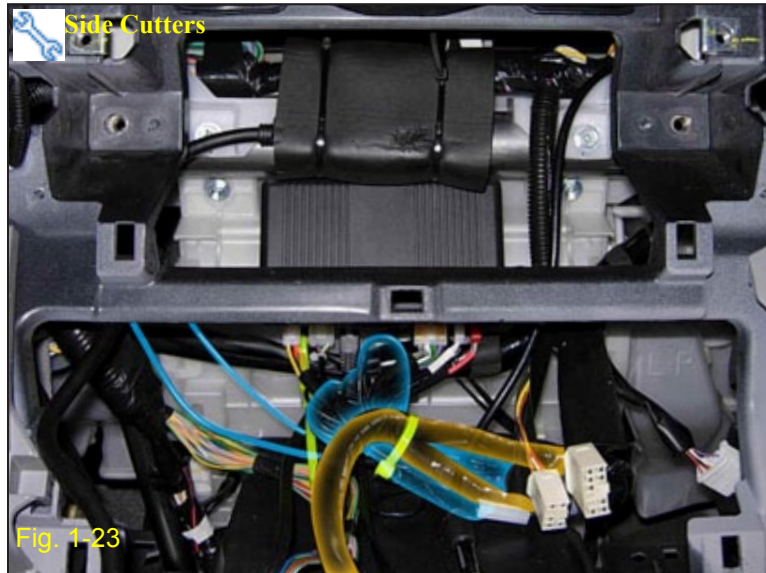

7. Finalize the Installation

- a. Bundle and secure the excess microphone and switch cable (highlighted in blue) to the main power harness (highlighted in orange) (Fig. 1-23).

1. Cut off excess wire ties.

- b. Connect the main power harness to the radio's matching connectors as needed.



NOTE: AVC-LAN (12 pin) connector may not be present on the vehicle's harness. Wire tie this connector to the harness unconnected, but ALWAYS connect the AVC-LAN (12 pin) connector into the radio.

If AVC-LAN (12 pin) connector is present on vehicle harness, connect to the jumper provided with BLU Logic unit.

If any other accessories are installed that connect to the head unit, BLU Logic should be the unit that plugs into the radio first.

- c. Reinstall the radio.
- d. Reinstall the radio trim panels.
- e. Position negative battery terminal at the original factory position (tighten the nut to 36 in-lbs (4.07 N.m)).



CAUTION: Do not touch the positive terminal with any tool during installation.

- f. Put the owner's manual in the glove box.

CHECKLIST – these points MUST be checked to ensure a quality installation.

Make sure radio and interior lights (if applicable) are turned off. Install fuse (short pin) for the following function checks.

Accessory Function Checks

	Check:	Look For:
<input type="checkbox"/>	Factory Radio	Turn on the radio and verify that the BLU Logic Module will mute the audio. With the radio on, press the middle button on the BLU Logic switch and verify that the audio is muted.
<input type="checkbox"/>	Interface Kit	Verify the proper connection of the Interface kit by pressing and holding the middle button on the switch until you hear one (1) beep. NOTE: Pairing the module to a phone is not required. This is the customers (or dealers) responsibility.
<input type="checkbox"/>	Audio Output	Turn the balance to the L and verify that one (1) beep is coming from the left front speaker. Repeat for the (R) right front speaker

Vehicle Function Check

	Vehicle Function		Vehicle Function Detail
<input type="checkbox"/>	Audio AM/FM	<input type="checkbox"/>	Verify the proper operation of audio AM/FM.
<input type="checkbox"/>	Hazard Switch	<input type="checkbox"/>	Verify the proper operation of the hazard switch.
<input type="checkbox"/>	HVAC	<input type="checkbox"/>	Verify the proper operation of the air conditioning system.
<input type="checkbox"/>	NAV System (if equipped)	<input type="checkbox"/>	Confirm navigation operation by AVN diagnostics.
<input type="checkbox"/>	Left & Right Seat Heater Switch (if equipped)	<input type="checkbox"/>	Verify the proper operation of the L&R heater switch.
<input type="checkbox"/>	SRS Warning Light	<input type="checkbox"/>	Confirm SRS warning light illuminates for approximately 6 seconds with the ignition ON, and then goes out.
<input type="checkbox"/>	Tire Pressure Monitoring System (TPMS)	<input type="checkbox"/>	<i>Prior to TPMS activation and Pre- delivery Service (PDS) of the Vehicle the TPMS light will blink when IG is turned on.</i> <i>After TPMS activation and PDS of the Vehicle the TPMS light will illuminate for a few seconds and go off when IG is turned on.</i>

Turn off all components including radio and interior lights. Remove fuse (short pin) after function checks are complete. Check with your dealer/port to find out if this step is required.

Kit Service Information

	Item:	Location:
1	3-Amp in-line Fuse	The fuse is located behind the radio assembly. To replace, follow Step 1 through 5 to access the fuse location. NOTE: If the fuse is blown, the Hands Free BLU Logic will not turn on.